

AZ CUSTOM BUILDINGS POST FRAME PACKET



WELCOMES



AZ Custom Buildings, LLC is a leader in post frame construction, specializing in durable, cost-effective, and versatile structures for agricultural, commercial, and residential use. Whether you need a barn, workshop, or storage building, we deliver expert craftsmanship and custom solutions designed to fit your needs.

MEET OUR TEAM



Zach Larison

CEO

✉ zach@az-custom.com

What sets Zach apart is not just his technical expertise but also his client-centric approach. He believes in the power of open communication, collaboration, and the importance of turning client visions into tangible reality. Zach's leadership ensures that every project undertaken by AZ Custom Buildings exceeds client expectations.

Elijah Rasmussen

Crew Superintendent

✉ elijah@az-custom.com

Driven by a passion for craftsmanship and meticulous attention to detail, Elijah approaches every task with a focus on doing the job right the first time. His hands-on approach and leadership skills have earned him the respect of both his team and clients alike.



Darren Dale

Salesman

✉ darren@az-custom.com

A lifelong entrepreneur, Darren joined AZ Custom for a new challenge and a team with big plans. With 35+ years in the Ag and Rodeo community from Wyoming to Texas, he knows the industry inside and out. His expertise helps bring custom solutions to your unique needs with quality craftsmanship and a personal touch.

MEET OUR TEAM

Brooklyn Barker

Administrative Consultant



brooklyn@az-custom.com

Brooklyn's dedication to client satisfaction is at the heart of her work. She believes in the power of clear communication, efficient project management, and meeting client expectations at every step of the process. Her role ensures that clients' needs are not just met but exceeded.



Brian Ozaeta

General Construction Crew Member

With over 10 years in the construction industry, Brian is passionate about learning new techniques, working with a team, and building projects that stand the test of time. As part of our General Construction crew, he specializes in bringing projects across the finish line with precision and dedication.



Abraham Aguliar

General Construction Crew Member

Fresh out of high school, Abraham joined our team with a passion for hands-on work and a strong desire to learn. He thrives in an environment that values patience and growth, and his adventurous spirit keeps the crew motivated. Abraham is a great reminder that everyone starts somewhere, and his dedication makes him a valued part of our team.





BID PROCESS

01

INITIAL CONSULTATION & SITE MEETING

- We start with a site visit to discuss your vision, needs, and project goals.
- Our team assesses the location to ensure the best placement and construction approach.

02

BUILDING DESIGN & APPROVAL

- We create a custom building draft based on your specifications.
- The design is sent to you for review, and we make adjustments as needed.
- We continue refining the design until you are 100% satisfied.

03

MATERIAL QUOTE & CONTRACT

- Once you approve the final design, we request material pricing from our manufacturer.
- We then email you a formal Building Contract along with a detailed bid package, including a hard copy of the bid.
- If revisions are needed, we make adjustments and repeat this step until your design is fully customized.
- Our bid process allows for as many revisions as the customer needs to ensure that when construction starts, the customer will get their dream building, limiting the need for change orders, which can drastically change the project price and timeline.



CONSTRUCTION PROCESS

01

CONTRACT SIGNING & SCHEDULING

- After you sign the contract, we schedule material delivery based on:
 - The builder's availability to start your project.
 - The manufacturer's delivery schedule for materials.

02

DIRT WORK & SITE PREPARATION

- Before construction begins, dirt work is completed to properly level and prepare the site.
 - This includes grading, compaction, and drainage preparation to ensure a stable foundation.
 - This step is not required to be completed by AZ and can be managed by the customer if they choose.
- Should the project have plumbing, any site work for this needs to be completed during this phase.

03

CONSTRUCTION PROCESS

- Once materials arrive, we aim to have a builder on-site within two weeks.
- Our professional builders complete your post-frame construction with precision and craftsmanship.
- After construction is finished, you will complete a walkthrough to ensure everything meets your expectations.

04

OTHER PHASES

- Once the final building payment is received, we schedule the next phase we are contracted for; we complete sub-phases in the following order:
 - Plumbing Rough In
 - Concrete
 - Electrical
 - Insulation
 - Interior Sheeting
 - Overhead Door Installation
 - Gutter Installation



AZ'S DESIGN

Our Standard Design

- 3-Ply 2"x6" Sidewall Posts with Up-Lift Cleats on 8' Centers with Quikrete in each post hole.
- Pre-Engineered Trusses with a 5# Bottom Cord, 4/12 Pitch (30#/120mph) on 4' Centers with 2' o/c 2 x 4 SPF #2 Roof Purlins Spaced every 4'.
- 2"x4" SPF Wallboards on 2' Centers (#2 Lumber).
- House Wrap on the Roof, Walls, & Gables.
- 29 Gauge Pro Q Plus Panel Metal with 40-Year Baked Enamel Attached Using Screws.

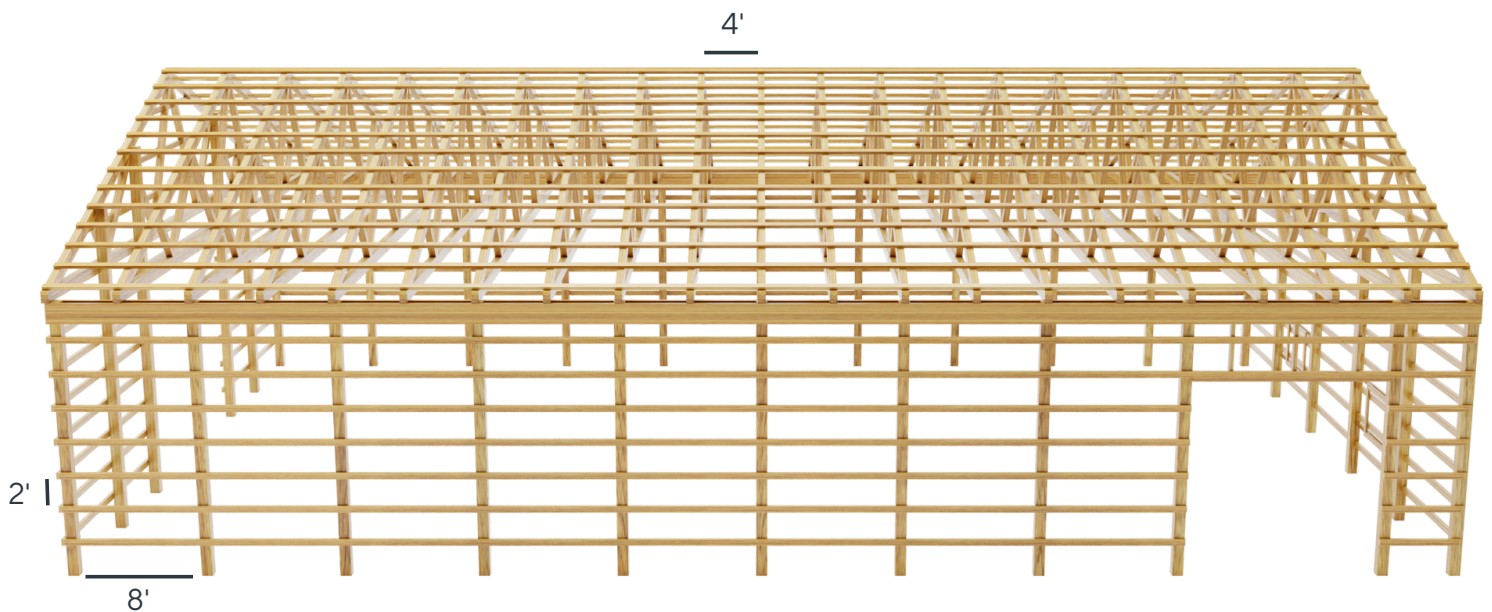

These guiding principles are essential for all AZ Custom Buildings. While we fully support your vision for a custom building, these standards remain constant, ensuring that we create a residence built to last!



FAQ

01 What Building do you Build?

The straightforward answer is AZ Custom Buildings. Our Founder and CEO collaborated with engineers to develop a post-frame building design that met his standards for quality and structure. This ensures that every building sold is one he would personally choose to construct for himself.

02 How did you Land on this Design?

During our time in the industry, we decided to select the finest elements from the best buildings currently available on the market and integrate them into our building design.

03 Do Truss and Post Spacing Make That Big of a Difference in My Building's Structural Integrity?

In summary, using more lumber results in a sturdier structure. By positioning our posts at 8-foot intervals and the trusses at 4-foot intervals, we guarantee that each building complies with the highest industry standards, ensuring its durability for a lifetime.

04 Can You Build a Post Frame Building without Putting Posts in the Ground?

Yes, this method is known as Bracket Building. Instead of digging a traditional 4-foot post hole and pouring concrete at the bottom, we prepare and pour a footing followed by the building's slab and attach the posts to the footing using anchor bolts.

05 When is a Bracket Building a Better Option?

A Bracket building is a superior choice for constructing Barndominiums, as it keeps all lumber elevated and away from the ground. This method helps prevent wood rot as the home ages.

06 What if I want to Provide Some of my Own Materials?

Every project has its own distinct characteristics, and what is effective for one may not apply to another. We are here to help explore the materials the customer wishes to provide and identify the most effective methods to accomplish that as we proceed through the bidding process.

07 What if there are Extra Materials after my Project is Completed?

The straightforward answer is that there will not be excess. We have perfected our process to ensure we have the right materials, along with a buffer, to guarantee that miscuts or defective lumber do not affect your project's timeline. You are purchasing a complete building, not just the individual materials. Additionally, there are instances when we need to deliver materials intended for other projects to your job site, based on the locations of upcoming jobs. Another way to consider this is: if we didn't order enough materials, would you be willing to cover our oversight?

08 What is Covered Under your Warranty and for How Long?

AZ Custom Buildings, LLC guarantees that work will meet accepted practices and specifications with a one-year warranty against defects. This warranty excludes damage from material characteristics or post-construction modifications and is non-transferable. It becomes effective only after full payment, at which point the company will assign all third-party warranties for materials to the customer.

09 What Can I Expect for a Timeline?

Our company is committed to ensuring that projects progress smoothly and are completed promptly as they come in. Once you sign off on your project, we aim to have your materials prepared for delivery within 45 days. However, we generally hold all deliveries until we are 2-4 weeks away from the builder's arrival to uphold the highest standards of quality. Our builders are subcontractors, and upon signing your project, we issue them a labor contract to reserve a spot on their schedule. The timeline for completion once a builder arrives on site varies based on the size and complexity of your project. Additionally, we must account for weather conditions; factors such as wind, snow, and rain can prolong the duration of your project. It's crucial to understand that all projects are completed in the order they are signed. Therefore, any delays with the project preceding yours may trigger a chain reaction.

10 What Other Services do you Offer

Custom Building Design - Project Management - Excavation - Concrete - Insulation - Plumbing - Electrical - Gutters - Final Touches



CORE VALUES

- **Accountability:** An obligation or willingness to accept responsibility.
- **Collaboration:** Working with someone to produce or create something.
- **Efficiency:** Achieving maximum productivity with minimum wasted effort or expense.
- **Respect:** Due regard for the feelings, wishes, rights, or traditions of others.
- **Transparency:** Having thoughts, feelings, or motives that are easily perceived.

In selecting the core values that guide our company, we focused on what matters most to us when the roles of customer and service provider are reversed. Every decision, from selecting suppliers to determining the ideal customer fit, is grounded in these principles. We genuinely believe that by treating our customers as we wish to be treated, we can provide them with the best possible experience throughout their Custom Barndominium journey.

We are excited to work with you and look forward to your Custom Barndominium build.
Zach and the rest of the AZ Custom Buildings Team

Members of:

